

PARTS No.CSBC5SP

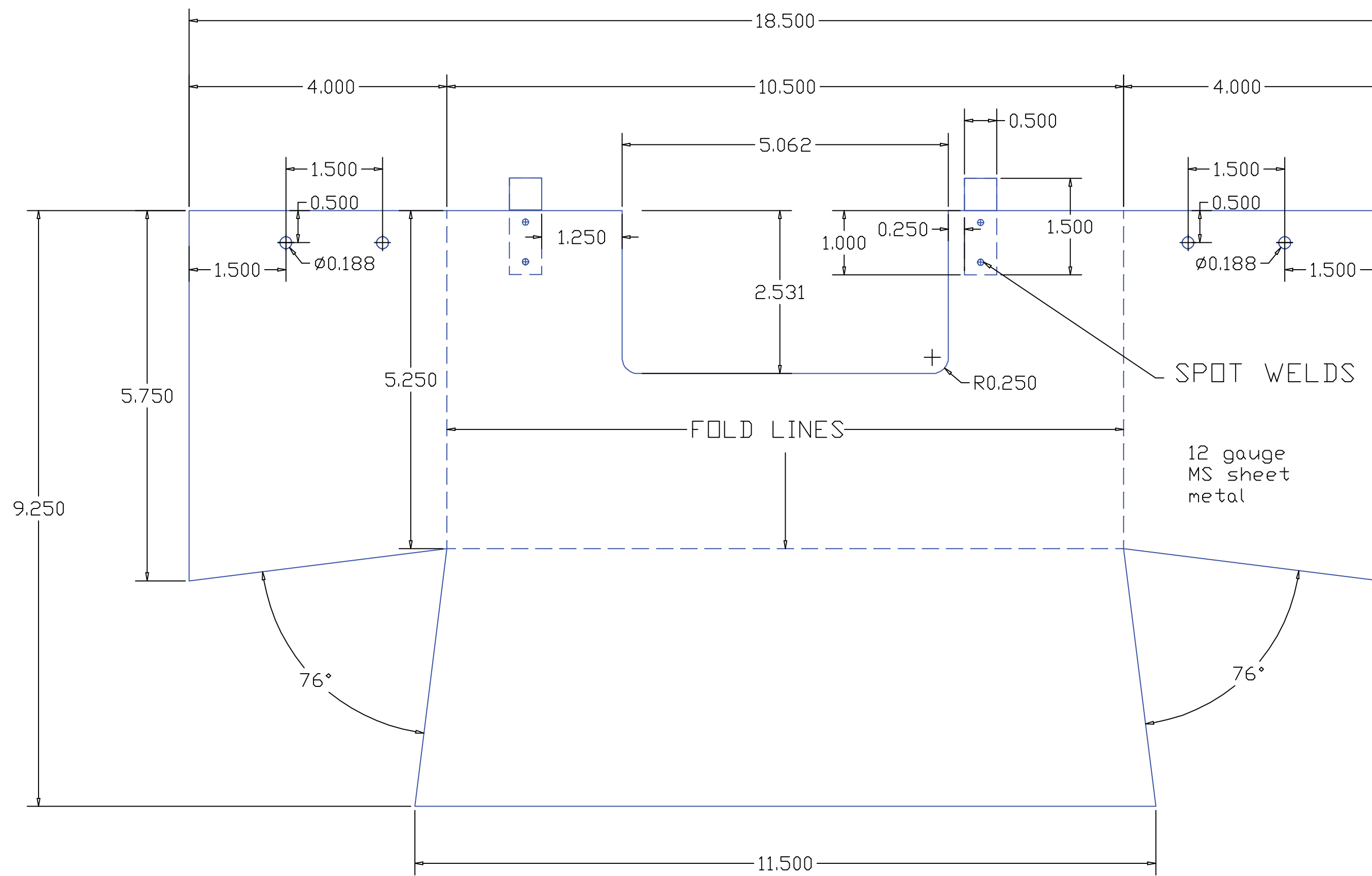

Guide clips 4 pcs per unit, spot welded on the inside of the cover as shown

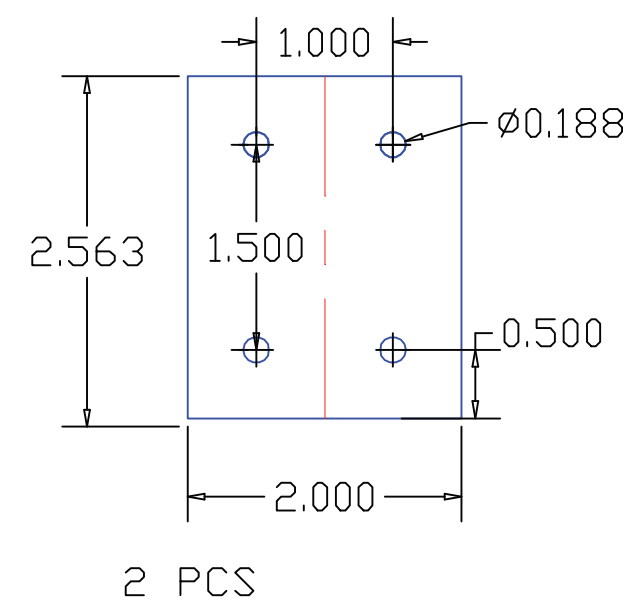
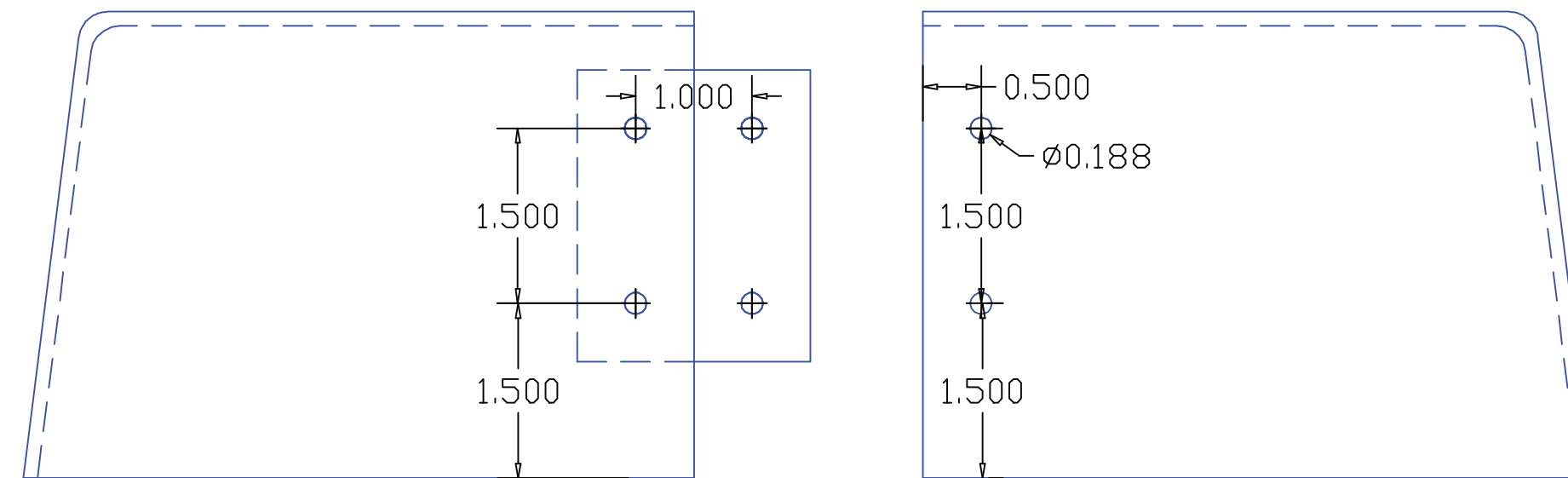
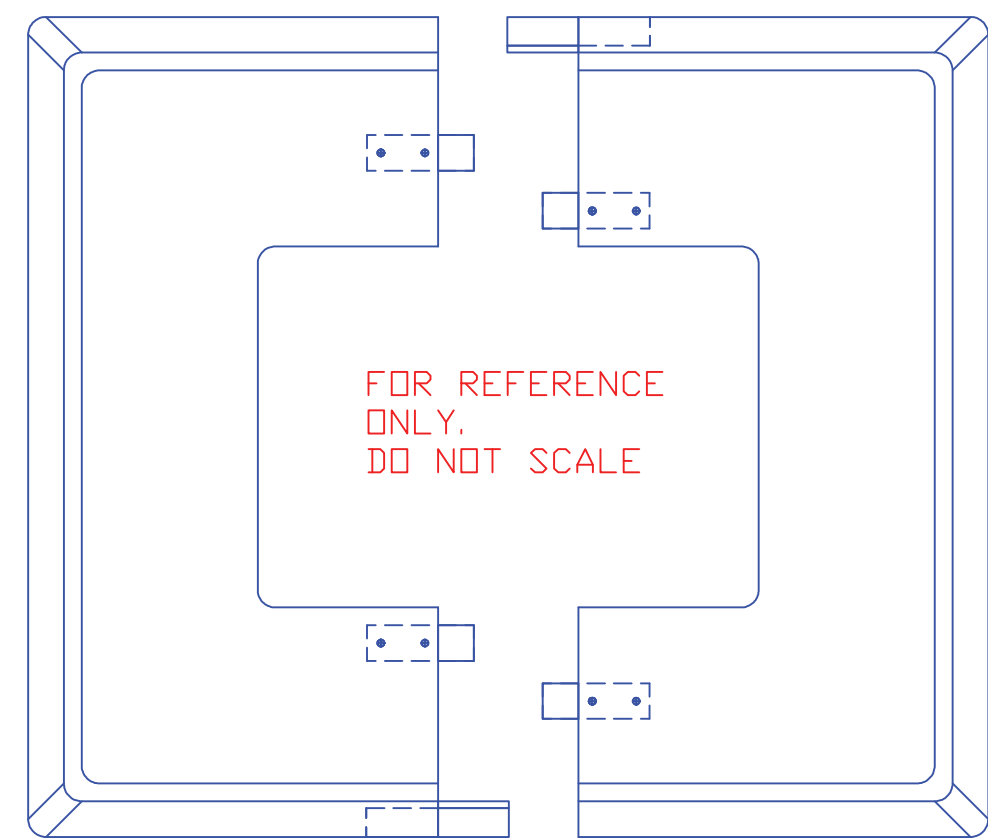

THE 2 IDENTICAL HALVES JOINED TOGETHER ON SITE WITH 3/16" x 3/8" SS POP-RIVETS

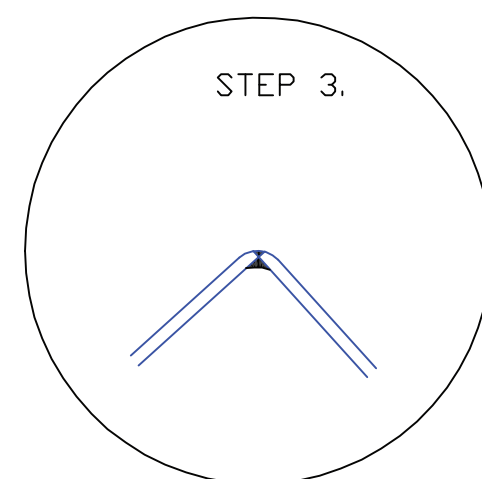
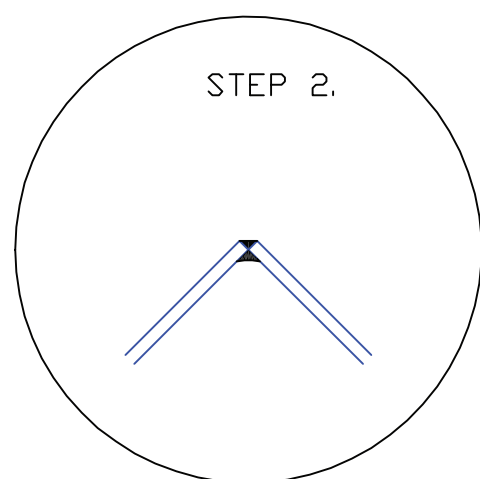
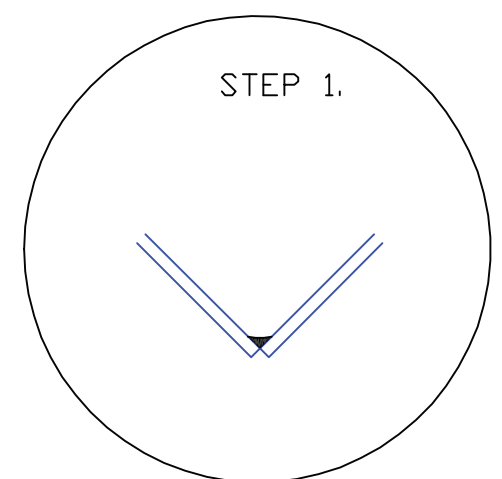

MATERIAL: 12 GAUGE MS SHEET METAL
IT'S IMPORTANT TO SHEAR (NOT PLASMA CUT) THE SHEET METAL INTO 9.250" X 18.500" BLANKS
THE CORNERS SHOULD ALSO BE NOTCHED BY MECHANICAL MEANS LIKE A SPECIAL NOTCHING TOOL MOUNTED ON AN IRONWORKER

GENERAL:

- UNLESS NOTED USE ONLY THE LATEST ISSUES OF ANY APPLICABLE CODES, STANDARDS OR REGULATIONS
- UNLESS NOTED ALL CONSTRUCTION SHALL CONFORM TO THE APPLICABLE STATE OR NATIONAL BUILDING CODE
- VERIFY ALL DIMENSIONS AND REPORT ANY DISCREPENCIES TO THE CONSULTANT BEFORE PERFORMING ANY WORK
- ALL STRUCTURAL MEMBERS ARE NEW UNLESS NOTED OTHERWISE
- ALL DIMENSIONS ARE IN MILLIMETERS UNLESS NOTED OTHERWISE

STRUCTURAL STEEL:

- STEEL DESIGN, FABRICATION AND ERECTION: ASTM A36 SHEET METAL STANDARD SPECIFICATION FOR CARBON STRUCTURAL STEEL
- ALL STRUCTURAL STEEL IS NEW AND SHALL CONFORM TO ASTM A123/A123M-17 STANDARD SPECIFICATION FOR ZINC (HOT-DIP GALVANIZED) COATINGS ON IRON AND STEEL PRODUCTS
- ALL U-BOLTS, ANCHOR BOLTS AND THREADED BARS SHALL CONFORM TO ASTM A307
- WELDED STEEL CONSTRUCTION (METAL ARC WELDING) SHALL CONFORM TO AWS D1.1, STRUCTURAL WELDING CODE STEEL

DESIGN LOADS:

- STEEL STRUCTURE AND ANCHOR BOLTS DESIGNED IN ACCORDANCE WITH AASHTO STANDARD SPECIFICATIONS FOR STRUCTURAL SUPPORTS FOR HIGHWAY SIGNS, LUMINAIRES AND TRAFFIC SIGNALS FOR A 44.7 M/A (100 MPH) WIND LOAD
- STEEL STRUCTURE AND ANCHOR BOLTS MEET THE REQUIREMENT OF THE FOLLOWING STANDARDS:
 - NATIONAL BUILDING CODES OF AMERICA
 - ASTM A123/A123M-17 STANDARDS SPECIFICATION FOR ZINC (HOT-DIP GALVANIZING) COATINGS ON IRON AND STEEL PRODUCTS

Square Pole Basecover

STRAHNET™
STRATEGIC HIGHWAY SUPPLY NETWORK LLC

baseplatecover.com

www.strahnet.com

www.poletopolenetwork.com

DRAWN BY : J K R

09/25/2018

DRAWING NO. CSBC5S18.1